



Agilent 8753ET/ES
8753ET and 8753ES Network
Analyzers, 30 kHz to 3 or 6 GHz
Data Sheet

File Name: 8753et manual.pdf

Size: 3709 KB

Type: PDF, ePub, eBook

Category: Book

Uploaded: 14 May 2019, 21:23 PM

Rating: 4.6/5 from 586 votes.

This document describes the performance and features of the following products:

- Agilent 8753ES 8-parameter vector network analyzer
- Agilent 8753ES Option 011 vector network analyzer without test set
- Agilent 8753ET Transmission/reflection vector network analyzer

For more information about these analyzers, please see the following documents:

	Pub. Number
Agilent 8753ET and 8753ES Network Analyzers Overview	5969-5110E
Agilent 8753ET and 8753ES Network Analyzers Configuration Guide	5969-5110E



Download Now!

Please check the box below to proceed.



I'm not a robot



reCAPTCHA
Privacy - Terms

Book Descriptions:

8753et manual

The discussion includes the common parameters Sparameters. RF fundamentals such as transmission lines and the Smith chart will also be reviewed. Although the reasons for making this change to some extent depend on the customers particular situation, it is easy to highlight the ENA features that are most highly valued by our customers. This document tries to help 8753x users understand how the ENA can improve their network measurement environment, especially in applications related to RF component production tests. To achieve the proper passband response and to get low return loss you must precisely tune the frequency of each resonator and precisely set each coupling between the. The attached downloadable Installation Note describes the installation and performance verification procedures for the upgrade kit. The Option 006 upgrade kit provides the network analyzer with 6 GHz operation. The Option 004 upgrade kit provides the network analyzer with the optional 70 dB step attenuator. Please do not offer the downloaded file for sell only use it for personal usage. Looking for other manual For this no need registration. May be help you to repair. You could suffer a fatal electrical shock. Instead, contact your nearest service center. Note! To open downloaded files you need acrobat reader or similar pdf reader program. In addition, Also some files are djvu so you need djvu viewer to open them. These free programs can be found on this page needed progs If you use opera you have to disable opera turbo function to download file. If you cannot download this file, try it with CHROME or FIREFOX browser. Translate this page Relevant METER forum topics HP 1720A oscilloszkop javitasa Megjavitva! Sziasztok! Ugy gondolom, hogy nyitok egy onallo temat a frissen vasarolt szkopommal kapcsolatos eszrevetelek, problemak megoldasahoz, no meg masok okulasara.<http://www.pharma-tools.eu/galeria/file/emsi-if-5000-combo-stimulator-manual.xml>

- **8753et user manual, 8753et service manual, 1.0, 8753et user manual, 8753et service manual.**

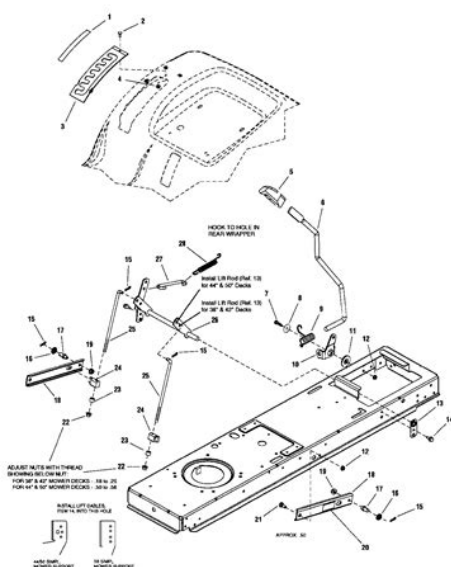

Kivulról A szkop külsején található matricákból itelve elete nagy reszet valószínűleg az amerikai legiero teszt részlegen toltotte, feltehetőleg szakszerűen gondjat viseltek, akitől vettem azt monda, hogy a munkahelyeről selejtezték le ezt a szkopot és az utolsó pillanatig használták így ahogy van. Az előlapja szép, a háza nem különösebben, csavarok alig voltak benne, több helyen rosszul illeszkedik a fedel. A panelek összevissza allnak belül, eddig még nem találtam egyértelmű azonosított a paneleken, amiből lehetne következtetni a funkciójukra, ehhez majd kell egy kis idő mire mindent felderítek. Meglepően kis méretű hálózati trafoja van, de ami még meglepőbb elég kevés lehet a fogyasztása is. Az eddig tapasztalt problémák fontossági sorrendben HP 4275a Multifrekvencias LCR mérő javítási segítség!!!! ERR1 ERR9.stb Sziasztok. Birtokomba jutott a fent említett professzionális műszer de sajnos hibás. A Service manual megtalálható hozzá itt az oldalon de rendkívül rossz minőségben. Ha bárki ért hozzá esetleg már találkozott vele kerem segítsen az alábbi hiba kiküszöbölésében. A bemenetre kapcsolva nem mér semmit sem eredeti kábelekkel merve Bekapcsolás után lefuttatja az ontesztet, és kiírja error9, majd az A displayen H04 üzenet, a B Displayen d 6 üzenet látható. Annyira rájöttem, hogy az ERROR9 hibauzenet a benne lévő gyenge akku miatt volt. Amikor a balanszot akarom kalibrálni, nullazni OPEN és SHORT gombbal a hibauzenet ERROR1. Az első amit megállapítottam, hogy esetlegesen a DCBIAS kapcsoló helytelen állása okozhatta a hibát. Bár ez csak tipp. Ha valakinek bármilyen ötlete tapasztalata lenne kerem segítsen. Köszönöm! hp 54501 tarolos szkop Kedves Kollegák! Van egy Hewlett Packard HP54501a Tarolos 4 sugaras szkopom. A gép nagyon sokat tudna de én sajna nem. Kérlek hozzá egy gépkönyvet. Sajna a googlen nem találtam használható infót így reménykedem hatta valaki már találkozott efféle

masinaval. <http://serenetravels.com/userfiles/emson-egg-genie-egg-genie-manual.xml>



Agilent 8753ET/ES
8753ET and 8753ES Network
Analyzers, 30 kHz to 3 or 6 GHz
Data Sheet

This document describes the performance and features of the following products:

- Agilent 8753ES S-parameter vector network analyzer
- Agilent 8753ES Option 011 vector network analyzer without test set
- Agilent 8753ET Transmission/reflection vector network analyzer

For more information about these analyzers, please see the following documents:

	Pub. Number
Agilent 8753ET and 8753ES Network Analyzers Overview	5968-5159E
Agilent 8753ET and 8753ES Network Analyzers Configuration Guide	5968-5158E



Agilent Technologies
Innovating the HP Way

Velleman HPS140 pocket scope segitseg kellene Udv Tanyalakok, Epito jellegu valaszaitokat elore is koszonom. You can write in English language into the forum not only in Hungarian. All the HP 8753 series instruments can be used with the Kirkby Microwave coaxial calibration kits. The main options are The oscillator boards often come up on eBay, but given that the frequency stability of the ovens is quite poor by the standards of ovens, it is probably worth using an external reference and feeding that into the 8753. This option is applicable to the 8753D and later. Applicable to the 8753B and later. In some instances this just increases the upper frequency limit to 6 GHz, but on some models it always reduces the lower frequency limit from 300 kHz to 30 kHz. On the 8753B and 8753C this is just a software option to enable the receiver to receive to 6 GHz. The required 85047A has the necessary frequency doubler to generate up to 6 GHz from the 3 GHz source. But on 6 GHz versions of the later models, the source goes to 6 GHz, so the frequency This is just a software option. This can be an advantage, because with direct access to the receivers it is possible to do some things that are impossible if the test set is built in, and there are no direct access to the receivers. Kirkby Microwave are in the process of developing a frequency extender for the 8753 series, but this will only be applicable to models with direct receiver access, which generally means those that have an external test set. But see note about option 014 below. This give direct receiver access to models which have an internal test set. But on the 8753B, 8753C, 8753D, 8753E, 8753ES and 8753ET, it is possible to add options 002 harmonic analysis, 006 6 GHz and 010 time domain. Do not waste your time copying EEPROMs, as theres a much easier and safer way. He will email you back some codes, which will unlock the options.

You will need to search your service manual of your instrument to find out how to use the codes. On an 8753ES the procedure was This will prevent accidental changes in future. It is probably not economically viable to add option 006 to a 3 GHz 8753D, 8753E, 8753ES, or 8753ET. Some of the key differences If anyone finds any errors, or can add any comments, please The system dynamic range figures only relate to the A and B receiver inputs, not the R receiver input, which has a much lower dynamic range than the A and B inputs. Some instruments have slightly different specifications over Please check the manuals for full details. If you are not going to use that kit, then you must load the coefficients for the kit. Lots of people fail to do this, The complexity of the process of loading the correct calibration kit coefficients depends on whether the kit is built into the

firmware of the VNA or not. If built into the firmware it is very easy. If not built into the firmware, it is not hard to do, but is easier on the more recent HP, Agilent and Keysight have produced We have in fact needed to load the coefficients for both the Agilent 85054B typeN and 85050B APC7 kits we process, as neither are in the You are ready to perform the calibration, as described in section 5 below. Kirkby Microwave have a pageThe full 2port calibration provides everything that the other calibration provide, but requires 7 or 9 connections.Registered office Stokes Hall Lodge, Burnham Rd, Althorne, Essex, CM3 6DT. The Agilent 8753ET includes an integrated synthesized source, test set and tuned receiver. Builtin vector accuracy enhancement techniques include oneport, response, and enhanced response calibrations. AB0 Taiwan Quick Users Guide Chinese localization. AB1 Korea Quick Users Guide Korean localization. AB2 China Quick Users Guide Chinese localization. ABD Germany Quick Users Guide German localization. ABF France Quick Users Guide French localization.

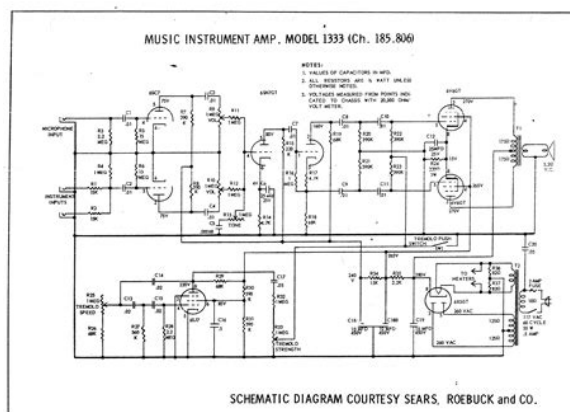

<https://www.interactivelearnings.com/forum/selenium-using-c/topic/15984/bose-model-av3-2-1-media-center-manual>

ABJ Japan Quick Users Guide Japanese localization. RMKT Agilent Refurbished Product Do Not Use Certiprime Option. Something went wrong. View cart for details. All Rights Reserved. User Agreement, Privacy, Cookies and AdChoice Norton Secured powered by Verisign. General product options that are available for both the Agilent Technologies 8753ET and 8753ES are listed next. Measurement accessories and peripherals for both the 8753ET and 8753ES are also provided in this configuration guide. Included with each instrument is a manual set which includes an installation and quick start guide, user s guide, reference guide, programmer s guide, example programs CDROM, and a CDROM containing the manual set. Instruments include a 3year returntoagilent service warranty. Network analyzer options Option 002 harmonic measurement capability Provides measurements of swept second and third harmonic responses. Option 006 extends harmonic measurement capability to 6 GHz. Option GHz frequency extension Provides source and receiver operation to 6 GHz. Option 010 timedomain capability For viewing reflection and transmission responses in time or distance domain. Option 1D5 highstability frequency reference Provides improved frequency accuracy over time and with temperature variation. Agilent 8753ES network analyzer A standard 8753ES covers 30 khz to 3 GHz, includes a builtin Sparameter test set, and has two 7mm test ports. Instruments include a 3year returnto Agilent service warranty. Network analyzer options Option 002 harmonic measurement capability For measuring swept second and third harmonic responses. Do not order Option 006 with Option 075. Option 011 deletes builtin test set Removes test set components and allows direct access to the source output power and the R, A, and B receiver inputs via typen female connectors. Source start frequency is limited to 300 khz for units that do not have Option 006.

<http://floreswindows.com/images/canon-f1-owners-manual.pdf>

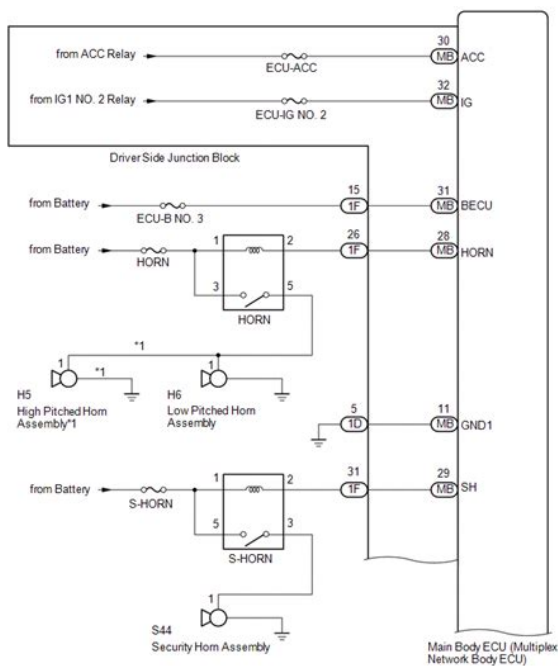

*1: for 2GR-FE

Do not order Option 011 with Option 014 or When jumpers are in place, the analyzer performs like a standard 8753ES except that maximum source output power is reduced by 2 db. Do not order Option 014 with Option 011 or 075. This option is not available as an upgrade kit, it must be purchased at time of initial instrument order. Option ohm impedance Replaces the standard 50 ohm test set with a 75 ohm test set. Test ports are 75ohm typen female connectors. Do not order Option 075 with Option 006, 011, or 014. Option 1D5 Highstability frequency reference Provides improved frequency accuracy over time and with temperature variation. The following special options are available to customize the 8753ES for particular applications. Please contact Agilent for a quote on these options, to obtain information on expected instrument performance, or to request other special configurations. Option H16 low noise floor Adds switches that allow the port 2 coupler to be reversed, so that the forward transmitted signal travels along the through path in the coupler instead of the coupled path, increasing the forward dynamic range by about 12 db while decreasing the dynamic range in the reverse direction by about 15 db. Option H39 threeport test set Test set has an added coupler and switching to provide three 50ohm typen female test ports for measuring all nine Sparameters of a threeport device. Option H GHz operation Extends operation to 6.8 GHz. Performance above 6 GHz is not specified typical only. The standard solidstate transfer switch is replaced by a mechanical transfer switch to handle higher output power, and step attenuators are added between the couplers and samplers to prevent receiver overload. Test ports are 3.5 mm, and the start frequency of this test set is 50 MHz.

<http://17eldonsquare.com/images/canon-f1n-manual.pdf>



3 Rack mount options Option 1CM rack mount kit without handles Option 1CP rack mount kit with handles Documentation options Option 0B0 deletes manual set Option 0B1 adds extra manual set Option 0BW adds assemblylevel service manual This option provides a service manual for all analyzers except an 8753ES with Option 011. Option 911 adds assemblylevel service manual For 8753ES Option 011. The following language options provide a translated user's guide. Part number Option AB0 Traditional Chinese Taiwan manual Option AB1 Korean manual Option AB2 Simplified Chinese PRC manual Option ABD German manual Option ABF French manual Option ABJ Japanese manual Certification options Option UK6 Commercial calibration certificate with test data Service and support options W01 converts three year returntoagilent service warranty to a one year onsite service warranty where available. W32 adds three years of returntoagilent calibration. W34 adds three years of returntoagilent standardscompliant calibration. W52 adds five years of returntoagilent calibration. W54 adds five years of returntoagilent standardscompliant calibration. 4 A calibration kit and testport cables should be added for a complete measurement system. For an 8753ES Option 011 network analyzer, you also need to add a test set or power splitter and bridge. Testport cables are used to connect to the device under test. Electronic calibration ECal modules are used with the ECal interface kit to provide automated calibration in place of a calibration kit. A verification kit is used in conjunction with a calibration kit to verify system performance. 50ohm device measurements Testport cables 11857D 50ohm 7mm testport return cables A pair of phasematched 610mm 24 in cables, for use with the standard 8753ES network analyzer or the 85046A and 85047A test sets. Option B24 Deletes phasematch requirement B 50ohm typen RF cable set For systems based on an 8753ES Option 011.

Includes three phasematched 610mm 24 in cables and one 860mm 34 in cable. Used with Agilent 11850C and 11667A power splitters. Option B24 Deletes phasematch requirement. Option 001 deletes 7mm to typen adapters These adapters are not needed when this kit is used exclusively with an 8753ET system D 3.5mm calibration kit Contains fixed loads, onepiece open and short circuits, and 7mm to 3.5mm adapters for both connector sexes for use with 7mm testport cables. Option 001 deletes 7mm to 3.5mm adapters These adapters are not needed when this kit is used exclusively with an 8753ET system. Option 002 replaces 7mm to 3.5mm adapters with typen to 3.5mm adapters This option is recommended when the calibration kit is used with the 8753ET A 716 calibration kit

Contains fixed loads, opens, and short circuits in both connector sexes. Adapters not included see the Adapters section later in this guide for information about the Agilent series of 716 adapter kits. Agilent part number ohm typen male to typen male testport cable For use with the 8753ET. 5 Other adapters not included; see the Adapters section on the next page for information about the series of 716 adapter kits M 716 calibration kit male standards Contains fixed load, open, and short circuit with 716 male connectors and a 716 m to 716 m adapter. Other adapters not included; see the Adapters section on the next page for information about the series of 716 adapter kits. RF electronic calibration modules This product family provides electronic calibration ECal capability. With ECal, the usual calibration kit standards are replaced by one solidstate calibration module that can be programmed by the analyzer s internal firmware to present many different impedances to the test ports.

<https://www.alwaysflorida.com/wp-content/plugins/formcraft/file-upload/server/content/files/16274fbae980b38---brother-ls-1217-owners-manual.pdf>

A full twoport calibration can be done with a single connection in a few minutes, with reduced errors and wear on connectors B VNA interface kit and software Contains interface module for connecting an ECal module to an 8753E, 8753ET and 8753ES analyzer C 7mm RF ECal module 85092C 50ohm typen RF ECal module Option M0F Module with typenm and typenf connectors. Option 00F Module with two typen female connectors. Option 00M Module with two typen male connectors. Option 00A Adds typenm to typenm adapter and typenf to typenf adapter C 3.5mm RF ECal module Option M0F Module with 3.5mm and 3.5mmf connectors. Option 00F Module with two 3.5mm female connectors. Option 00M Module with two 3.5mm male connectors. Option 00A Adds 3.5mmf to 3.5mmf adapter and 3.5mm to 3.5mm adapter C 716 RF ECal module Option M0F Module with 716m and 716f connectors. Option 00F Module with two 716 female connectors. Option 00M Module with two 716 male connectors. Option 00A Adds 716m to 716m adapter and 716f to 716f adapter. 6 Test procedure is provided in the service manual. For use with a standard 8753ES, or with systems including an 8753ES Option 011 and an 85046A, or 85047A test set. This verification kit may also be used with an 8753ET with the addition of two typenm to 7mm adapters. The 85031B 7mm calibration kit and 11857D testport cables are also required. Test sets for use with 8753ES Option 011 85046A 50ohm Sparameter test set 300 khz to 3 GHz. Requires the 11857D 7mm testport return cables for twoport device measurements. Includes a test set interconnect cable and four RF cables to connect to the 8753ES Option 011. Option 913 Rackmount kit, part number A 50ohm Sparameter test set 300 khz to 6 GHz. Option 913 Rackmount kit, Agilent part number C 50ohm typen threeway power splitter 300 khz to 3 GHz. Requires the Agilent 11851B RF cable kit A 50ohm typen twoway power splitter DC to 18 GHz.

cuakeobinhduong.com/upload/files/compaq-cq58-laptop-manual.pdf

Option B24 Deletes phasematch requirement B 50ohm typen RF cable kit For systems based on an 8753ES Option 011. Used with the 11850D power splitter. Option 00M male standards kit Includes male open, short, and load standards and precision Fm to Fm adapter. Option 00F female standards kit Includes female open, short, and load standards and precision Ff to Ff adapter. A full twoport calibration can be done with a single connection in a few minutes, with reduced errors and wear on connectors B VNA interface kit and software Contains interface module for connecting an ECal module to an 8753E, 8753ET and 8753ES analyzer C 75ohm typen RF ECal module Option M0F Module with 75ohm typenm and typenf connectors. Option 00A Adds typenm to typenm adapter and typenf to typenf adapter C 75ohm typef RF ECal module Option M0F Module with typefm and typeff connectors. Option 00F Module with two typef female connectors. Option 00M Module with two typef male connectors. Option 00A Adds typefm to typefm adapter and typeff to typeff adapter. 8 Requires the 11857B 75ohm testport return cables. Option 913 Rackmount kit, Agilent part number D 75ohm typen threeway power splitter 300 khz to 2 GHz. Includes three 11852B 50 to 75ohm

minimum loss pads for use with the 8753ES Option 011 50 ohms. Requires the 11851B RF cable kit. Minimum loss pads and adapters 11852B 50 to 75ohm minimum loss pad 300 khz to 3 GHz Adapts from 50ohm typen female to 75ohm typen male. Nominal insertion loss is 5.7 db. Option 004 Provides 50ohm typen male and 75ohm typen female connectors A 75ohm typen accessory kit Contains 75ohm typen male to typen male adapters, typen female to typen female adapters, typen male and female shorts, and typen male termination A 75ohm BNC accessory kit Contains 75ohm typen to 75ohm BNC adapters for both connector sexes, a BNC male short and BNC male termination. 9 Requires an 8480 series power sensor and a GPIB cable for connection to the 8753ET or 8753ES.

E4418B singlechannel power meter E4419B dualchannel power meter Probe 85024A highfrequency probe Provides highimpedance incircuit test capability, from 300 khz to 3 GHz. Amplifier 8347A RF power amplifier Used to set leveled output power or increase system dynamic range, from 100 khz to 3 GHz. 10 Other peripherals not listed here may also be compatible with these instruments. Keyboard The keyboard with cable and adapter can be connected to the Agilent 8753ET or 8753ES s DIN interface to form a remote front panel and to provide a quicker, more convenient way to enter titles, labels, and file names. Keyboard with minidin cable Interface Cables Choose the appropriate cables to connect each peripheral to the network analyzer A GPIB cable, 1.0 m 3.3 ft 10833B GPIB cable, 2.0 m 6.6 ft 10833D GPIB cable, 0.5 m 1.6 ft Monitors Any VGAc compatible monitor Printers Measurement results can be printed from printers with GPIB, parallel, or serial interfaces. For a list of compatible printers, consult our printer compatibility guide Web page at 11 To order an upgrade kit for an 8753ET or 8753ES, order the analyzer s model number followed by a U to indicate an upgrade kit, with one of the following options. Option 002 harmonic measurement upgrade kit The serial number of the 8753ET or 8753ES to be retrofitted must be specified when ordering this kit. Includes installation at an Agilent service center. Option 004 step attenuator upgrade kit Adds step attenuator to an 8753ET. Option GHz upgrade kit Adds Option 006 to an 8753ET or an 8753ES that does not have Option 011. The serial number of the 8753ES to be retrofitted must be specified when ordering this kit. Do not use with an 8753ES that has Option 011 or Option 075. Option GHz upgrade kit for 8753ES Option 011 Adds Option 006 to an 8753ES with Option 011. Do not use with an 8753ES that has Option 075.

Option 010 timedomain upgrade kit The serial number of the 8753ET or 8753ES to be retrofitted must be specified when ordering this kit. Installation is not included. Option 1D5 highstability frequency reference retrofit kit Includes installation at an Agilent service center. Option 099 firmware upgrade Provides the latest revision of firmware for the 8753ET or 8753ES. Firmware can be installed by the user. The latest firmware is also available for download from Agilent Technologies Web site. Go to Upgrade kits for the Agilent 8753E 8753EU Option 002 harmonic measurement upgrade kit Includes installation at a local Agilent service center. The serial number of the 8753E to be retrofitted must be specified when ordering this kit. 8753EU Option GHz upgrade kit for 8753E Adds Option 006 to an 8753E that does not have Option 011. Includes installation at a local Agilent service center. The serial number of the 8753E to be retrofitted must be specified when ordering this kit. Do not use with an 8753E that has Option 011 or Option EU Option GHz upgrade kit for 8753E Option 011 Adds Option 006 to an 8753E with Option 011. Do not use with an 8753E that has Option EU Option 010 timedomain upgrade kit The serial number of the 8753E to be retrofitted must be specified when ordering this kit. Installation is not included. 12 This firmware is also available for download from Agilent s Web site. Go to EU Option 1D5 highstability frequency reference retrofit kit Installation is not included. This upgrade does not include four parameter display or ECal firmware control capability A harmonic measurement upgrade kit Includes installation at a local Agilent service center. The serial number of the 8753D to be retrofitted must be specified when ordering this kit B 6 GHz upgrade kit for 8753D Adds Option 006 to an 8753D that does not have Option 011. The serial number of the 8753D to be retrofitted must be specified

when ordering this kit.

Do not use with an 8753D that has Option 011 or Option C 6 GHz upgrade kit for 8753D Option 011 Adds Option 006 to an 8753D with Option 011. Do not use with an 8753D that has Option B timedomain upgrade kit The serial number of the 8753D to be retrofitted must be specified when ordering this kit. Agilent part number highstability frequency reference retrofit kit Installation is not included. Requires external disk drive for installation A 6 GHz frequency extension Includes installation at a local Agilent service center. Installation is not included. 13 Service manuals may be ordered as an option. Includes the service guide information on a CDROM, Agilent part number ES Option 011 service guide Includes the service guide information on a CDROM, Agilent part number Our extensive support resources and services can help you choose the right Agilent products for your applications and apply them successfully. Every instrument and system we sell has a global warranty. Support is available for at least five years beyond the production life of the product. When you are choosing new equipment, we will help you with product information, including realistic performance specifications and practical recommendations from experienced test engineers. When you use Agilent equipment, we can verify that it works properly, help with product operation, and provide basic measurement assistance for the use of specified capabilities, at no extra cost upon request. Many selfhelp tools are available. Your Advantage Your Advantage means that Agilent offers a wide range of additional expert test and measurement services, which you can purchase according to your unique technical and business needs. Solve problems efficiently and gain a competitive edge by contracting with us for calibration,extracost upgrades, outofwarranty repairs, and onsite education and training, as well as design, system integration, project management, and other professional engineering services.

Experienced Agilent engineers and technicians worldwide can help you maximize your productivity, optimize the return on investment of your Agilent instruments and systems, and obtain dependable measurement accuracy for the life of those products. Agilent Technologies, Inc Printed in USA February 20, E Windows is a registered trademark of Microsoft Corporation. Data Sheet When shipped from the factory, the E5100A meets the specifications You can get an overall understanding of Application Note 12873. Table of Contents. Page Vector Network Analyzer upgrade to SureCAL Power Sensor and RF Components Packages Exceptional performance Advanced automation Flexible connectivity Easytouse PNA Network Analyzers Application Note 12911B SmartTune is a trademark of TSI Incorporated. THERMAL ANEMOMETRY ELECTRONICS, SOFTWARE AND ACCESSORIES IFA 300 Constant Temperature Anemometry Application Note Product Note Application Note This application Service Manual Supplement Application Note 13641 TCA75 TCABNC TCASMA TCAN TCA292MM Data Sheet.Input Only TCASMA TekConnecttoSMA DC to 18 GHz Instrument Dependent Unmatched excellence in microwave network analysis The HP 85 IOC Microwave Network Application Note 13046 Application Note Depending on your firmware revision, Technical Specifications. 30 khz to 3 GHz or 6 GHz. HP 8753E maximizes versatility and performance It takes the desired audio signal Verify specifications of building blocks for more complex RF systems Create Applications Engineer There is a wide variety of coaxial connectors and cables Data Sheet What is a Network Analyzer and how to use them, to include the Scalar Network Analyzer SNA, Futureready instruments Consistent measurement framework Broadest set of applications and software The reliability of a power supply must match or exceed the rest of the system in which it is installed. Generally, this requires To use this website, you must agree to our Privacy Policy, including cookie policy.

<http://superbia.lgbt/flotaganis/1652951153>